



The 8th IEEEJ International Conference on Image Electronics and Visual Computing

IEVC2024

National Cheng Kung University, Tainan City, Taiwan

March 11-14, 2024

Timetable

| Time | F. C. Room | ATI Room | Chi-Duan Building | Hall |
|----------------------|---|---|---|-------------|
| Mar. 11 (Mon) | | | | |
| 13:00 | Opening | | | |
| 13:20 | Keynote #1 | | | |
| 14:20 | Break | | | |
| 14:35 | 1A: Rendering | 1B: Modeling & Animation | | |
| Mar. 12 (Tue) | | | | |
| 9:00 | 2A: Computer Vision & 3D Image Processing (1) | 2B: Virtual, Augmented, and Mixed Reality (1) | 2C: Security and Privacy | |
| 10:20 | Break | | | |
| 10:35 | Poster FF | | | |
| 11:35 | Lunch | | | |
| 13:20 | | | | 4: Poster 1 |
| 14:35 | Break | | | |
| 14:50 | 5A: Image Recognition & Detection (2) | 5B: Virtual, Augmented, and Mixed Reality (2) | 5C: Image Recognition & Detection (1) | |
| 16:10 | Break | | | |
| 16:25 | 6A: Computer Vision & 3D Image Processing (2) | 6B: Artificial Intelligence and Deep Learning | 6C: Computer Vision & 3D Image Processing (3) | |
| Mar. 13 (Wed) | | | | |
| 9:00 | Keynote #2 | | | |
| 10:00 | Break | | | |
| 10:15 | | | | 7: Poster 2 |
| 11:30 | Lunch | | | |
| 13:15 | Excursion | | | |
| 18:30 | Banquet | | | |
| Mar. 14 (Thu) | | | | |
| 9:00 | 8A: Virtual, Augmented, and Mixed Reality (3) | 8B: Medical Image processing | | |
| 10:20 | Break | | | |
| 10:35 | Keynote #3 | | | |
| 11:35 | Lunch | | | |
| 13:20 | Special Session: Industry Forum | 9: Multimedia | | |
| 14:00 | | Break | | |
| 14:15 | | 10: Image Recognition & Detection (3) | | |
| 15:15 | | Break | | |
| 15:30 | | | | |
| 17:00 | Closing | | | |

Monday, March 11

13:00-13:20 Opening F. C. Room

13:20-14:20 Keynote #1 F. C. Room

Chair: Issei Fujishiro (Keio University)

Interactive Tangible Computing

Bing-Yu Chen (National Taiwan University)

14:35-16:15 Session 1A: Rendering F. C. Room

Chair: Katsumi Tadamura (Yamaguchi University)

- 1A-1 **Real-Time Rendering of Energy Wave Representation Using Transmitted Light**
Masaki Abe and Taichi Watanabe
- 1A-2 **Implementation of Global Illumination within Image-Based Distributed Rendering Architecture**
Wenxiang Yang, Asahi Yamada and Suguru Saito
- 1A-3 **Accelerated Ray Tracing Under Strong Gravity Influence by Symplectic Method with Adaptive Step Size**
Yusuke Kobayashi and Takafumi Koike
- 1A-4 **Multi-Kernel Denoising Autoencoder for Particle-Based Rendering**
Masahiro Morii, Amirul Haziq Bin Azman, Naohisa Sakamoto and Takuma Kawamura
- 1A-5 **Procedural Generation of Kitaehada Based on the Fold-and-Forging Process of Japanese Sword Making**
Hitomi Tanaka, Keiko Nakamoto, Yuki Asahina and Takafumi Koike

14:35-16:15 Session 1B: Modeling & Animation ATI Room

Chair: Koji Mikami (Tokyo University of Technology)

- 1B-1 **Physical Simulation of Human Body Model Considering Joint Range of Motion**
Shuhei Era, Kunio Yamamoto and Masaki Oshita
- 1B-2 **Blood Flow and Stress Distribution by the Model with a Blood Flow Control Mechanism**
Nobuhiko Mukai, Kohta Takayama and Youngha Chang
- 1B-3 **Procedural Modeling of Trees with Crown Shyness**
Yuchen Zhang, Toshiki Tanaka, Kai Lenz, Tomoya Ito, Yuriko Takeshima and Tsukasa Kikuchi
- 1B-4 **Visual Simulation of Tire Smoke Considering Load Shift and Frictional Heat**
Tomoya Tamagawa and Tomokazu Ishikawa
- 1B-5 **Editing Camera Work with Virtual Camera and 3D Printed Figures**
Shuntaro Kono, Kunio Yamamoto and Masaki Oshita

Tuesday, March 12

09:00-10:20 Session 2A: Computer Vision & 3D Image Processing (1) F. C. Room

Chair: Taichi Watanabe (Tokyo University of Technology)

- 2A-1 **A Study on Correction Method for Vertical Direction of Earthenware Fragments Based on 3D Measured Point Clouds**
Taishin Kawashima, Mengbo You, Tsutomu Kinoshita and Kouichi Konno
- 2A-2 **Real-Time Intuitive Interaction and Realistic Illumination for CT Volume Rendering**
Kousuke Katayama, Toru Higaki, Kazufumi Kaneda, Bisser Raytchev and Wataru Fukumoto
- 2A-3 **2D-To-3D Conversion Profiling of Monocular Food Images**
Yue-Cong Kuo, Gwo Giun Lee, Chin An Kuo and Natalie Tanjaya
- 2A-4 **An Efficient Smoothing Method for Texture Image for V-PCC Coding**
Shota Fujiwara and Seishi Takamura

09:00-10:20 Session 2B: Virtual, Augmented, and Mixed Reality (1) ATI Room

Chair: Shinji Mizuno (Aichi Institute of Technology)

- 2B-1 **Frequency and Kansei Evaluation of Tones That Change the Sence of Weights with Volume**
Kenji Mizutani, Hiroyuki Nagata, Shunya Matsumoto and Masaki Takeda
- 2B-2 **Investigating Factors Influencing Personal Space Perception in the Metaverse**
Peeraya Sripian and Takashi Ohta
- 2B-3 **Lyrics onto Cityscape: An Augmented Reality System with Visual Experience Harmonizing Music and Surrounding Cityscape**
Rin Izumi, Shuhei Kodama and Tokiichiro Takahashi

2B-4 **A Study on a Round Structure: The Spatial Comparison of Mongolian Ger and Geodesic Dome Using Virtual Environment**
Naranchimeg Usukhbayar, Peng Jiang and Takamitsu Tanaka

09:00-10:20 Session 2C: Security and Privacy Chi-Duan Building

Chair: Osamu Uchida (Tokai University)

2C-1 **Study on the Color Factor That Affects Feelings toward Visual Emergency Notification on Smartphones**

Jirarit Jirasukprasert, Peng Jiang, Satoshi Mikami and Takamitsu Tanaka

2C-2 **Comparative Visualization of Depiction Distribution in Media Mix Works**

Kotomi Iida, Kai Lenz and Yuriko Takeshima

2C-3 **Digital Seal and Digital Sign Using Color-Coded Round or Rounded Rectangular Symbols with Digital Signatures**

Nobuyuki Teraura, Isao Echizen and Keiichi Iwamura

10:35-11:35 Session 3: Poster FF F. C. Room

Chair: Eri Yokoyama (Osaka Institute of Technology)

13:20-14:35 Session 4: Poster1

LBP-02 **Multimedia Information Gateway Service**

Kiyoshi Tanaka

LBP-04 **High-Precision Video Retrieval through Image Generation**

Kazuya Ueki, Haruki Sato, Yuma Suzuki, Takumi Takada, Hiroki Takushima and Takayuki Hori

LBP-05 **Object Detection Method for Drone Videos Using Optical Flow**

Takahiro Shindo, Kein Yamada, Taiju Watanabe and Hiroshi Watanabe

LBP-06 **Extension of Tactical Board Capable of Determining Normative Offensive Sequences for Rugby Sevens**

Kotaro Yashiro, Soma Hirose and Yohei Nakada

LBP-07 **Image Coding for Machines with Objectness-Based Feature Distillation**

Kei Iino, Shunsuke Akamatsu, Hiroshi Watanabe, Shohei Enomoto, Akira Sakamoto and Takeharu Eda

LBP-08 **Creation and Evaluation of a Board Game for Environmental Learning: Gamification for Learning about River Water Quality and Ecosystems**

Ryo Ishii and Mizuho Iinuma

LBP-09 **The Relationship between the Variation in Drawn Lines and Reaction Time in a Simulated Right Turn Situation**

Taisei Inoue, Motonori Ishibashi and Norimasa Yoshida

LBP-10 **Anomaly Detection Using Mist Score from Surveillance Videos**

Takayuki Tozawa and Hironobu Abe

LBP-11 **Occlusion-Robust Faces Recognition Using Multi-Tasking Model with Part Segmentation**

Yuta Akutsu and Akira Kubota

LBP-12 **Edge-Cloud Collaborative Object Detection Model with Feature Compression**

Shunsuke Akamatsu, Kei Iino, Hiroshi Watanabe, Shohei Enomoto, Akira Sakamoto and Takeharu Eda

LBP-13 **Development of a Piano Learning Mobile Application Using Augmented Reality and Hand Tracking**

Wen-Hsin Li, Cheng-Ta Yang and Mizuho Iinuma

LBP-14 **Sentinel-1 Image Shoreline Monitoring Technology in Waisanding Sandbar Based on Deep-Learning**

Kuo-Yu Liao, Bing-Jiun Hsieh, Kuan-Yu Huang, Pei-Yin Chen, Hsiao-Wei Chung, Cheng-Chien Liu, Wen-Chang Yang, Meng-Syue Li and Kun-I Lin

LBP-15 **The Effect of Edge Information in Stable Diffusion Applied to Image Coding**

Hiroshi Watanabe, Luoxu Jin, Taiga Hayami, Takeshi Chujoh, Yukinobu Yasugi, Sujun Hong, Zheming Fan and Tomohiro Ikai

LBP-16 **A Preliminary Study on Quantitative Evaluation of Cataract Using Lens Images**

Kousuke Yasuzawa, Kiyoshi Tanaka, Yoshiki Tanaka, Sho Yokoyama, Kei Ichikawa and Kazuo Ichikawa

LBP-17 **A Preliminary Study on Pupil Tracking in Cataract Surgery Using YOLOv8**

Hayato Yamada, Yoshiki Tanaka, Seiji Tokiwa, Sho Yokoyama, Kiyoshi Tanaka and Kazuo Ichikawa

LBP-18 **Attentive Listening System Using Generative Images and an Affective Emoji**

Keiko Ochi, Koji Inoue, Divesh Lala and Tatsuya Kawahara

14:50-16:10 Session 5A: Image Recognition & Detection (2) F. C. Room

Chair: Seishi Takamura (Hosei University)

5A-1 **Automatic Image Selection System for High School Baseball Player Photos**

Eiji Fukuzawa, Akane Niimi, Yosuke Yamano and Hideaki Tamori

5A-2 **Online Hand-Drawing Pattern Classification Using Sketch-RNN**

Shione Ishida and Kyoko Sudo

- 5A-3 **Estimating the Way of Grasp Complex Contoured Pieces**
Mika Ishino, Kaito Aoki and Kyoko Sudo
- 5A-4 **VigNet: Semiautomatic Generation of Vignette Illustrations from Video**
Mayu Namai and Issei Fujishiro

16:25-17:45 Session 5B: Virtual, Augmented, and Mixed Reality (2) ATI Room

Chair: Kenji Mizutani (Tokai University)

- 5B-1 **Task-Dependent Optimization of Stereophonic Sound in VR Contents**
Ryota Tanaka and Yasunari Obuchi
- 5B-2 **Stability Enhancement in VR Hand Manipulation through Dynamic Truss Structure Connections**
Hiroyoshi Komobuchi and Susumu Maruno
- 5B-3 **An Examination of Motion Analysis during Weight Illusion by Impression Change of the Own Body**
Joichiro Muraoka, Yusei Muraishi, Kosei Tomioka, Mie Sato and Naoki Hashimoto
- 5B-4 **Chronological Changes in the Form of Festival Preparation Works and Their Influence on the Local Community Bonds**
Mika Enomoto and Yasuharu Den

14:50-16:10 Session 5C: Image Recognition & Detection (1) Chi-Duan Building

Chair: Takafumi Koike (Hosei University)

- 5C-1 **Color Compensation for Underwater Images of Battleship Yamato**
Tasuku Yamamoto and Masashi Baba
- 5C-2 **EEG-Based BCI System Using Deep Learning to Control PC Mouse**
Ayoub Mlatem and Tomoko Ozeki
- 5C-3 **Open Vocabulary 3D Multiple Object Tracking through Stereo Camera**
Qingxiang Wang and Hiroshi Hanaizumi
- 5C-4 **Guidance Map Transformation for Lighting Control in Patch-Based Style Transfer**
Muhammad Arief, Hideki Todo and Koji Mikami

16:25-17:45 Session 6A: Computer Vision & 3D Image Processing (2) F. C. Room

Chair: Suguru Saito (Tokyo Institute of Technology)

- 6A-1 **Tube-NeRF: Fast Synthesis of Stereo Novel Views Observed from within a Long Passage**
Yutaro Koike and Takafumi Koike
- 6A-2 **Quantifying the Effect of Image Transformation Using Hypersphere Embedding**
Daiki Ishiguro and Tomoko Ozeki
- 6A-3 **Auxiliary Selection: Optimal Selection of Auxiliary Tasks Using Deep Reinforcement Learning**
Hidenori Itaya, Tsubasa Hirakawa, Takayoshi Yamashita and Hironobu Fujiyoshi
- 6A-4 **Estimating Wiped Rate of Cleaning Process in Semiconductor Manufacturing Using DNN and 3D Body Tracking**
Takehiro Nagata, Li-Wei Cheng, Chun Xie, Hidehiko Shishido and Itaru Kitahara

16:25-17:45 Session 6B: Artificial Intelligence and Deep Learning ATI Room

Chair: Hiroshi Watanabe (Waseda University)

- 6B-1 **Learning Weight Parameter Distribution in Neural Network**
Satoru Fujita
- 6B-2 **FoodGAN: Realistic Cuisine Image Synthesis with Multi-Scale GANs**
Weiyi Xia and Satoru Fujita
- 6B-3 **Deep Neural Network 3D Reconstruction Using One-Shot Color Mapping of Light Ray Direction Field**
Hiroshi Ohno and Takashi Usui
- 6B-4 **Data Augmentation for Image and Clinical Data in Classification of Parotid Tumors by Deep Learning**
Koji Kinoshita, Yumi Onishi, Masaharu Isshiki, Sohei Mitani and Yuki Irifune

16:25-17:45 Session 6C: Computer Vision & 3D Image Processing (3) Chi-Duan Building

Chair: Tomokazu Ishikawa (Toyo University)

- 6C-1 **Development of Interaction Methods Using Physical Objects with a Stereoscopic Mid-Air 3D Image**
Mayumi Takazaki and Shinji Mizuno
- 6C-2 **Frame-Break: Enhancing the Stereoscopic Effect of an Anamorphosis-Based Naked-Eye 3D Imaging System**
Keita Tokunaga and Issei Fujishiro
- 6C-3 **Portable See-through AR Using Parallax Barrier-Based Autostereoscopic 3D Tablet**
Ryotaro Motomiya, Rintaro Akiyama and Takafumi Koike

Wednesday, March 13

09:00-10:00 Keynote #2

F. C. Room

Chair: Kiyoshi Tanaka (Shinshu University)

The Principle and Future Prospects of AIGC Generative Models

Jhing-fa Wang (National Cheng Kung University)

10:15-11:30 Session 7: Poster2

- CTP-01 **Method for Automatically Assigning Appropriate Elevation Values to a River Portion in Digital Elevation Model 5A Data**
Ryosuke Magata, Toshikazu Samura and Katsumi Tadamura
- CTP-02 **An Automatic Face Image Generation System with Pose and Facial Expression Difference for Game Characters Based on StyleGAN2**
Hironobu Abe and Qing Chen
- CTP-03 **A Study on Adaptive Estimation of Camera Extrinsic Using Building Structures to Acquire VR Spherical Images for Remote Control of Robots**
Yudai Onoda and Yoshikazu Yano
- CTP-04 **Real-Time 3D Video Communication System Using Stereo Video Capture and Autostereoscopic Display with Eye Tracking**
Kyoosuke Yanagida, Takafumi Koike, Goro Hamagishi and Hideya Takahashi
- CTP-05 **Preparation of Invisible QR Code Using Achromatic Colors by Thin Film Interference**
Hiromasa Ohsuka and Shuichi Maeda
- CTP-06 **Feature Analysis and Visualization of Title Logos in Japanese Manga**
Momoka Ito, Kai Lenz and Yuriko Takeshima
- LBP-21 **Visual Simulation of Dry Ice Sublimation in Water Using Flame Shape from Combustion Simulation**
Yuito Kobayashi, Kai Lenz, Tomoya Ito, Yuriko Takeshima and Tsukasa Kikuchi
- LBP-22 **Visual Simulation of Spaghetti Using XPBD**
Haruto Sato, Kai Lenz, Tomoya Ito, Yuriko Takeshima and Tsukasa Kikuchi
- LBP-23 **A Research on Enhancing GameFeel by Modifying Hit Stop Duration Based on Gaze Information**
Rena Tomizawa and Tomokazu Ishikawa
- LBP-24 **Proposal for a Coloring Support System for Beginners in Digital Illustration**
Seigi Sakai, Takahiro Yokoi, Tsuyoshi Saitoh and Mizuki Nakajima
- LBP-25 **A Method to Retrieve Drawings as References for Animators**
Masahiro Fuchiue and Suguru Saito
- LBP-26 **Computer Graphics Modeling of Human Speech Organs**
Makoto J. Hirayama
- LBP-27 **Modulated Reality Using Depth Fusion: Proposal of a New Type of Extended Reality**
Hideaki Takada, Masahiro Suzuki and Kazutake Uehira
- LBP-28 **3D Pose Estimation Using Time Series Data in Event-Based Video**
Kakeru Koizumi and Hiroshi Watanabe
- LBP-29 **Data Augmentation with 3D-Rendered Models for Livestock Recognition Using Drone Footage**
Kein Yamada, Takahiro Shindo, Taiju Watanabe and Hiroshi Watanabe
- LBP-30 **ISEM: Information Sharing System for Evacuation Center Management**
Osamu Uchida, Yoshihide Nakagawa, Wataru Noguchi and Kenji Okami

13:15-18:00 Excursion

18:30-20:00 Banquet

Nong Yuan Man Han Restaurant (濃園滿漢餐廳)

Address : No.248, Section 2, Changrong Rd, East District, Tainan City

Tel : +886 6-235-1133 or 6-237-6999

Thursday, March 14

| | | |
|--|--|------------|
| 09:00-10:20 | Session 8A: Virtual, Augmented, and Mixed Reality (3) | F. C. Room |
| | Chair: Takashi Ohta (Tokyo University of Technology) | |
| 8A-1 | Combination of Environmental Coefficients and Pedestrian Behavior toward Autonomous Vehicles Kenji Mizutani, Ryuto Masuda and Kouu You | |
| 8A-2 | A Verification Experiment Whether Overlaying a CG Image Can Enhance the Illusion of Taste Induced by Food Pairing Taiyo Taguchi and Tomokazu Ishikawa | |
| 8A-3 | An Examination of the Effects of Font Size on Reading in VR and on a Display Shogo Nishida, Kei Kanari and Mie Sato | |
| 8A-4 | Analysis of Moving Single Pictures to Improve the Sense of Presence Mio Yamada and Takafumi Koike | |
| 09:00-10:20 | Session 8B: Medical Image Processing | ATI Room |
| | Chair: Tomoko Ozeki (Tokai University) | |
| 8B-1 | 2D-3D Registration Method for X-Ray Image Using 3D Reconstruction Based on Deep Neural Network Pragyan Shrestha, Chun Xie, Hidehiko Shishido, Yuichi Yoshii and Itaru Kitahara | |
| 8B-2 | White Blood Cells Classification with YOLOv7: Single and Cascade Classification Approaches for Images Segmented by Cellavision DM96 Thalita Munique Costa, Yoko Usami, Mai Iwaya, Yuka Takezawa, Yuika Natori, Hernan Aguirre and Kiyoshi Tanaka | |
| 8B-3 | A Real-Time Polyp Detection Method Based on GhostAtt-YOLOv8 Phuong Thao Nguyen and Hiroshi Watanabe | |
| 8B-4 | A Computer-Aided-Diagnosis System for Hallux Valgus Ayumu Kubota, Hiroshi Hanaizumi, Yoshiteru Watanabe, Shungo Murai, Ryo Tohara and Nobuhide Kawabe | |
| 10:35-11:35 | Keynote #3 | F. C. Room |
| | Chair: Gwo Giun Lee (National Cheng Kung University) | |
| Bringing Generative AI to Your Fingertips TY Lin (MediaTek Inc.) | | |
| 13:20-17:00 | Special Session: Industry Forum | F. C. Room |
| | Organizers: Gwo Giun Lee (National Cheng Kung University) and Seishi Takamura (Hosei University) | |
| 13:20-14:00 | Session 9: Multimedia | ATI Room |
| | Chair: Kiyoshi Tanaka (Otsuma Women's University) | |
| 9-1 | Creation of a Digital Literary Map of Kawakami Village, Yoshino Gun, Nara Prefecture for Regional Revitalization Eri Yokoyama, Hiroshi Sunaga and Makoto J Hirayama | |
| 9-2 | Smartphone-Based Continuous Authentication Based on Flick Input Features Using Japanese Free Text Shuto Kinoshita and Yasushi Yamazaki | |
| 14:15-15:15 | Session 10: Image Recognition & Detection (3) | ATI Room |
| | Chair: Makoto Hirayama (Osaka Institute of Technology) | |
| 10-1 | Jewelry Image-to-Image Translation with Consistency Regularization and Data Augmentations Taiyo Nakagawa and Tomoko Ozeki | |
| 10-2 | Effect of visual saliency on emotions while viewing paintings Yuma Sasaki, Mie Sato and Kei Kanari | |
| 10-3 | Deformation Invariant Palmprint Recognition with Multiple-Resolution Feature Matching Mika Sakuma and Satoru Fujita | |
| 17:00-17:20 | Closing | F. C. Room |

Special session: Industry Forum
AI and the Era of Smart Semiconductors

Program

| | |
|--------------------|---|
| 13:20-13:30 | Opening Remarks |
| | Dr. Shouu-Jinn Chang (Distinguished Professor College of Electrical and Computer Engineering, NCKU, Taiwan) |
| 13:30-16:30 | Algorithm/Architecture Co-Design: From Algorithm to Architecture, and below ... |
| | Chair: Seishi Takamura (Hosei University, Visiting Senior Distinguished Scientist, NTT Corporation, Japan) |
| 13:30 | Invited Talk: SoC VLSI Physical Layouts and EDA Solutions to Enable Single-Digit Nanometer Semiconductor Volume Production for the Upcoming Artificial Intelligence Dr. Keh-Jeng Chang, Deputy Director (Taiwan Semiconductor Manufacturing Company (TSMC), Hsinchu, Taiwan) |
| 14:00 | Distinguished Lecture Host: Prof. Cheng-Ta Chiang (Chapter Chair IEEE CAS Society, Tainan Chapter, National Chia Yi University, Taiwan) IEEE CASS Tainan Chapter, Distinguished Lecture: Designing a Hardware Solution for Deep Neural Network Training Prof. Dongsuk Jeon (Seoul National University, Korea) |
| 15:15 | Break |
| 15:30 | Invited Talk: MediaGnosis: Towards Building Multimodal Foundation Model Dr. Ryo Masumura (NTT Corporation, Japan) |
| 16:00 | Invited Talk: Algorithm-Architecture Co-design for 4K HDR Video Applications in IC Design Industry Dr. He Yuan Lin (MediaTek, Taiwan) |
| 16:30-17:00 | Panel Discussion: Emerging trends in Algorithm/Architecture Co-Design for AI & Young Professions/Students in this New Era |
| | Chair: Gwo Giun Lee (National Cheng Kung University) Dr. Keh-Jeng Chang (TSMC), Prof. Dongsuk Jeon (SNU), Dr. He Yuan Lin, Eden Tsai (MediaTek) |

Organizers

Chris Gwo Giun Lee (Professor, National Cheng Kung University, Taiwan)
Seishi Takamura (Professor, Hosei University; Visiting Senior Distinguished Scientist, NTT Corporation, Japan)

Co-sponsors

College of Electrical Engineering and Computer Science, NCKU
Academy of Innovative Semiconductor and Sustainable Manufacturing, NCKU
APSIPA Industry Relations and Development
IEEE Signal Processing Society, Tainan Chapter, IEEE CASS Society, Tainan Chapter, Taipei Chapter: IEEE Solid-State Circuits Society, Tainan Chapter

Maps

Electrical Engineering Bldg. I (1F)

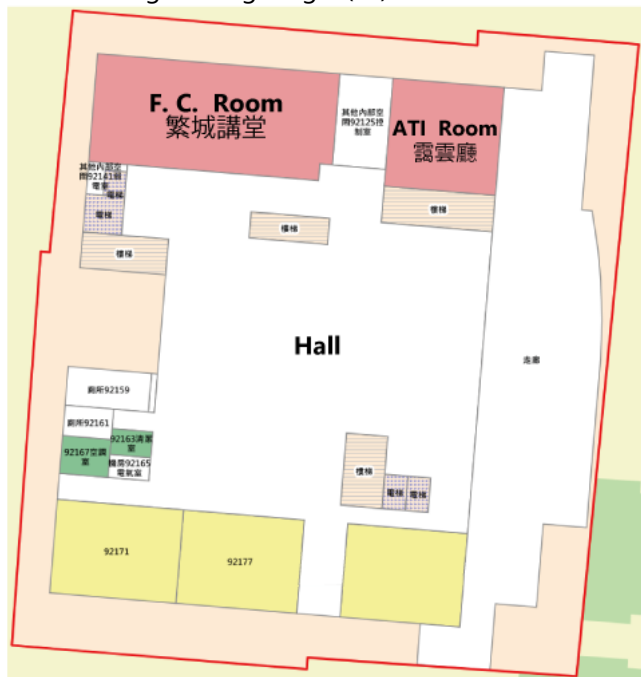

Chi Duan Bldg.

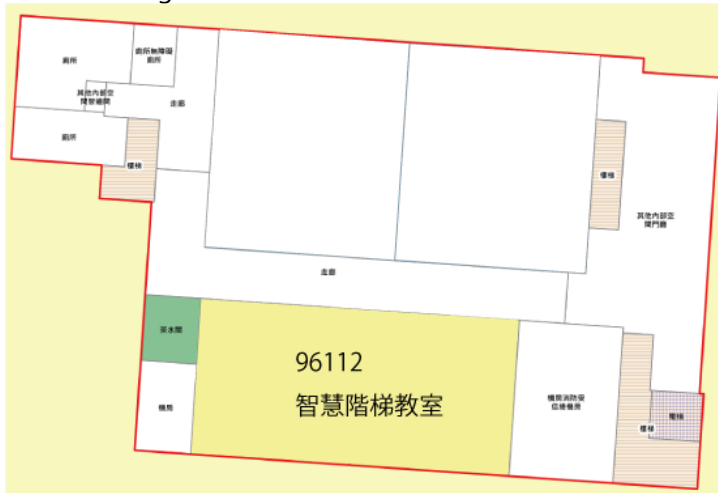

Conference Committee

Honorary Chairman

Naoki Kobayashi (Saitama Medical Univ.)

Conference Chair

Yuriko Takeshima (Tokyo Univ. of Tech.)

General Co-Chairs

Kitahiro Kaneda (NAGASE & CO., LTD.)

Gwo Giun (Chris) Lee (National Cheng Kung Univ.)

General Vice-Chair

Seishi Takamura (Hosei Univ.)

Technical Program Committee Chair

Osamu Uchida (Tokai Univ.)

Technical Program Committee Vice-Chairs

Yuki Igarashi (Ochanomizu Univ.)

Masahiro Ishikawa (Kindai Univ.)

Finance Chair

Kiyoshi Tanaka (Otsuma Women's Univ.)

Finance Vice-Chair

Eri Yokoyama (Osaka Institute of Technology)

Publication Chairs

Hideki Komagata (Saitama Medical Univ.)

Kai Lenz (Tokyo Univ. of Tech.)

Executive Advisors

Kiyoshi Tanaka (Shinshu Univ.)

Jhing Fa Wang (National Cheng Kung Univ.)

Sponsors

In cooperate with

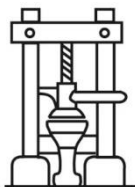

Special Session: Sponsored by

